

Lifting solutions

electric chain hoists

in keeping with european laws

R·W·M

Versatility and Efficiency

capacities from 125 kg through to 5,000 kg

RWM has through experience and research evolved its range of electric chain hoists to match the needs of today's customer requirements. Available in the following.

The W series hoist, with capacities from 125 kg through to 2,000 kg, available with eye suspension, close coupled push, geared and power travel trolleys to give maximum headroom.

The new innovative WR series hoist, with capacities from 1000 kg through to 5,000 kg available with eye suspension, close coupled push, geared and power travel trolleys designed to give exceptional low headroom.

Both W & WR series hoists are available with a comprehensive range of single and dual speeds. Also available built as an ultra low headroom hoist for applications with restrictive height.

With the numerous combinations of hoists and available voltages RWM can offer a solution to any of your material handling requirements.

W Series

electric chain hoists



Technical dimensional details W serie

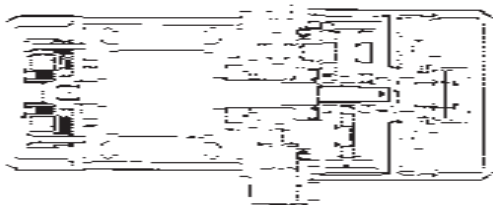

Electrical control panel

The panel is fully hard wired with all components mounted on a steel backing plate. The panel includes high quality contactor switches, a transformer for low voltage (24V) controls, brake rectifier, fuses and connector terminals.

Thanks to these high quality components, up to 240 operations per hour can be carried out. The electrical control panel is mounted in an IP65 plastic enclosure and follows the CEI-EN 60204 norms. In addition, the panel are fully compatible and interchangeable with a full range of hoist models.

Guide chain

The hoists central body and patented chain guide are machined from one single casting, this allows precise positioning of the load chain into the load sprocket.

The W-series range of electric chain hoists can be distinguished by the following; its extremely compact size giving the best possible closed headroom, its exceptional quality and its high levels of reliability. All are achieved by having the highest quality manufacturing standards, continuous improvements and quality control. All mechanical parts are examined under stringent conditions and rigorously tested, including long term performance testing to ensure the highest quality, efficiency and extended product life.

Lifting motor

The cylindrical parallel rotor is produced with single windings for single speed hoists or dual windings for dual speed hoists and all have class F insulation.

Manufacture in accordance with FEM class 2m, the duty cycle for single speed hoists is 40% and 10 + 30% for dual speed hoists. The supply voltage for these motors can be specified when ordering and they are available in a wide range of voltages, phases and hertz, thus making the RWM chain hoists again very versatile and capable of working in any environment.

The braking system of the chain hoist uses a 230V spring-activated electro magnetic brake which allows for quick and safe stopping allowing the load to be held at any desired height or position.

The chain hoist has an IP54 protection which protects it against dust, limited ingress and against low pressure jets of water from all directions, limited ingress, for standard indoor use. For other environments, please contact RWM.

Reduction gears

Found in the gear box's are epicycloid, totally enclosed and lubricated with a permanent high performance grease. The gears are manufactured from high tensile steel and are hardened and heat treated for smooth operation and maximum life span.

In addition, due to its sealed lubrication, the chain hoist can operate within a temperature range of -20°C to +60°C.

Overload by clutch

The slipping clutch is a safety device which limits both the up and down stroke of the chain hoist, by limiting a possible overload. It is constructed from asbestos free braking plates held under pressure by cup springs and is adjustable. Note: this is only a safety feature and should not be used as a working limit.

The clutch is setting at 15% respect the nominal capacity of hoist.



Type F-CS dimensions and technical specifications

| Model | Capacity kg | Speed m/min. | Kw | Pull of chain | Ø chain | A | B | B1 | C1 | C2 | C3 | C4 | D | D1 | E | F | G | H | I | L | M | N | R | S | T | U | Ø wheel | Weight kg F | CS |
|---------|-------------|--------------|---------|---------------|---------|-----|-----|----|-----|-----|-----|-----|-----|----|-----|----|----|----|-----|-----|-----|----|----|-----|----|----|---------|-------------|-----|
| 125W5 | 125 | 5 | 0,5 | 1 | 4 | 355 | 255 | 70 | 130 | 225 | 200 | 435 | 175 | 38 | 110 | 12 | 31 | 8 | 196 | 100 | 348 | 65 | 50 | 150 | 14 | 60 | 50 | 27 | 33 |
| 125W8 | 125 | 8 | 0,5 | 1 | 4 | 355 | 255 | 70 | 130 | 225 | 200 | 435 | 175 | 38 | 110 | 12 | 31 | 8 | 196 | 100 | 348 | 65 | 50 | 150 | 14 | 60 | 50 | 27 | 33 |
| 125W12 | 125 | 14 | 1 | 1 | 4 | 355 | 255 | 70 | 130 | 225 | 200 | 435 | 175 | 38 | 110 | 12 | 31 | 8 | 196 | 100 | 348 | 65 | 50 | 150 | 14 | 60 | 50 | 29 | 35 |
| 125W14 | 125 | 1-4 | 0,2-0,5 | 1 | 4 | 355 | 255 | 70 | 130 | 225 | 200 | 435 | 175 | 38 | 110 | 12 | 31 | 8 | 196 | 100 | 348 | 65 | 50 | 150 | 14 | 60 | 50 | 27 | 33 |
| 125W28 | 125 | 2-8 | 0,2-0,5 | 1 | 4 | 355 | 255 | 70 | 130 | 225 | 200 | 435 | 175 | 38 | 110 | 12 | 31 | 8 | 196 | 100 | 348 | 65 | 50 | 150 | 14 | 60 | 50 | 29 | 35 |
| 125W312 | 125 | 3,5-14 | 0,2-0,5 | 1 | 4 | 355 | 255 | 70 | 130 | 225 | 200 | 435 | 175 | 38 | 110 | 12 | 31 | 8 | 196 | 100 | 348 | 65 | 50 | 150 | 14 | 60 | 50 | 29 | 35 |
| 250W5 | 250 | 5 | 0,5 | 1 | 4 | 355 | 255 | 70 | 130 | 225 | 200 | 435 | 175 | 38 | 110 | 12 | 31 | 8 | 196 | 100 | 348 | 65 | 50 | 150 | 14 | 60 | 50 | 27 | 33 |
| 250W8 | 250 | 8 | 0,8 | 1 | 4 | 355 | 255 | 70 | 130 | 225 | 200 | 435 | 175 | 38 | 110 | 12 | 31 | 8 | 196 | 100 | 348 | 65 | 50 | 150 | 14 | 60 | 50 | 27 | 33 |
| 250W12 | 250 | 12 | 1 | 1 | 5 | 355 | 255 | 70 | 130 | 225 | 200 | 435 | 175 | 38 | 110 | 12 | 31 | 8 | 196 | 100 | 348 | 65 | 50 | 150 | 14 | 60 | 50 | 29 | 35 |
| 250W16 | 250 | 16 | 1 | 1 | 5 | 355 | 255 | 70 | 130 | 225 | 200 | 435 | 175 | 38 | 110 | 12 | 31 | 8 | 196 | 100 | 348 | 65 | 50 | 150 | 14 | 60 | 50 | 29 | 35 |
| 250W14 | 250 | 1-4 | 0,2-0,5 | 1 | 4 | 355 | 255 | 70 | 130 | 225 | 200 | 435 | 175 | 38 | 110 | 12 | 31 | 8 | 196 | 100 | 348 | 65 | 50 | 150 | 14 | 60 | 50 | 27 | 33 |
| 250W28 | 250 | 2-8 | 0,25-1 | 1 | 4 | 365 | 255 | 70 | 130 | 235 | 200 | 460 | 185 | 38 | 110 | 12 | 31 | 8 | 196 | 100 | 358 | 65 | 50 | 150 | 14 | 60 | 50 | 35 | 35 |
| 250W312 | 250 | 3-12 | 0,25-1 | 1 | 5 | 400 | 255 | 70 | 130 | 235 | 200 | 490 | 185 | 38 | 110 | 12 | 31 | 8 | 196 | 100 | 358 | 65 | 50 | 150 | 14 | 60 | 50 | 35 | 41 |
| 500W4 | 500 | 4 | 0,8 | 1 | 5 | 370 | 255 | 70 | 130 | 225 | 200 | 435 | 175 | 38 | 110 | 12 | 31 | 8 | 196 | 100 | 370 | 65 | 50 | 150 | 14 | 60 | 50 | 29 | 35 |
| 500W6 | 500 | 6 | 0,8 | 1 | 5 | 370 | 255 | 70 | 130 | 225 | 200 | 435 | 175 | 38 | 110 | 12 | 31 | 8 | 196 | 100 | 370 | 65 | 50 | 150 | 14 | 60 | 50 | 29 | 35 |
| 500W8 | 500 | 8 | 1 | 1 | 5 | 380 | 255 | 70 | 130 | 235 | 200 | 460 | 185 | 38 | 110 | 12 | 31 | 8 | 196 | 100 | 380 | 65 | 50 | 150 | 14 | 60 | 50 | 35 | 41 |
| 500W12 | 500 | 12 | 1,5 | 1 | 5 | 380 | 255 | 70 | 116 | 235 | 200 | 460 | 185 | 38 | 110 | 12 | 31 | 8 | 196 | 100 | 380 | 65 | 50 | 150 | 14 | 60 | 50 | 35 | 41 |
| 500W14 | 500 | 1-4 | 0,25-1 | 1 | 5 | 380 | 255 | 70 | 116 | 235 | 200 | 460 | 185 | 38 | 110 | 12 | 31 | 8 | 196 | 100 | 380 | 65 | 50 | 150 | 14 | 60 | 50 | 35 | 41 |
| 500W28 | 500 | 2-8 | 0,4-1,8 | 1 | 7 | 410 | 275 | 75 | 116 | 260 | 230 | 490 | 200 | 58 | 125 | 18 | 36 | 12 | 290 | 162 | 430 | 73 | 70 | 200 | 18 | 90 | 70 | 44 | 57 |
| 1000W4 | 1000 | 4 | 1 | 1 | 7 | 435 | 275 | 75 | 116 | 240 | 230 | 475 | 190 | 58 | 125 | 18 | 36 | 12 | 290 | 162 | 440 | 73 | 70 | 200 | 18 | 90 | 70 | 41 | 54 |
| 1000W6 | 1000 | 6 | 1,6 | 1 | 7 | 445 | 275 | 75 | 116 | 260 | 230 | 490 | 200 | 58 | 125 | 18 | 36 | 12 | 290 | 162 | 440 | 73 | 70 | 200 | 18 | 90 | 70 | 44 | 57 |
| 1000W14 | 1000 | 1-4 | 0,4-1,8 | 1 | 7 | 445 | 275 | 75 | 116 | 260 | 230 | 490 | 200 | 58 | 125 | 18 | 36 | 12 | 290 | 162 | 440 | 73 | 70 | 200 | 18 | 90 | 70 | 44 | 57 |
| 1000W8 | 1000 | 8 | 2 | 1 | 10 | 520 | 315 | 90 | 185 | 275 | 235 | 510 | 245 | 62 | 135 | 40 | 41 | 15 | 290 | 162 | 505 | 92 | 70 | 320 | 22 | 90 | 70 | 67 | 83 |
| 1000W28 | 1000 | 2-8 | 0,5-2 | 1 | 10 | 520 | 315 | 90 | 185 | 290 | 235 | 525 | 245 | 62 | 135 | 40 | 41 | 15 | 290 | 162 | 505 | 92 | 70 | 320 | 22 | 90 | 70 | 69 | 85 |
| 1500W4 | 1500 | 4 | 2 | 2 | 10 | 618 | 315 | 90 | 185 | 275 | 235 | 510 | 245 | 62 | 135 | 40 | 41 | 15 | 290 | 162 | 595 | 92 | 70 | 320 | 22 | 90 | 70 | 82 | 98 |
| 1500W14 | 1500 | 1-4 | 0,5-2 | 2 | 10 | 618 | 315 | 90 | 185 | 290 | 235 | 528 | 245 | 62 | 135 | 40 | 41 | 15 | 290 | 162 | 595 | 92 | 70 | 320 | 22 | 90 | 70 | 87 | 102 |
| 2000W4 | 2000 | 4 | 2 | 2 | 10 | 618 | 315 | 90 | 185 | 275 | 235 | 510 | 245 | 62 | 135 | 40 | 41 | 15 | 290 | 162 | 595 | 92 | 70 | 200 | 22 | 90 | 70 | 82 | 98 |
| 2000W14 | 2000 | 1-4 | 0,5-2 | 2 | 10 | 618 | 315 | 90 | 185 | 290 | 235 | 525 | 245 | 62 | 150 | 40 | 41 | 15 | 290 | 162 | 595 | 92 | 70 | 200 | 22 | 90 | 70 | 87 | 102 |

All RWM electric chain hoists are supplied with a chain collector, low voltage 24v pendant with emergency stop button and are chained for 3m H.O.L. Other heights of lift are available upon request. • Standard classification of use FEM 2m, number of starts per hour 240 • Duty cycle 40% for single speed hoists and 10+30% for dual speed hoists.

Type CE-CM dimensions and technical specifications

| Model | Capacity kg | Speed m/min. | Kw | Pull of chain | Ø chain | C1 | C2 | C3 | D | H | I | L | M | N | O | P | R | S | T | V | Ø wheel | Weight kg CE | CM |
|---------|-------------|--------------|---------|---------------|---------|-----|-----|-----|-----|----|-----|-----|-----|----|-----|-----|----|-----|----|----|---------|--------------|-----|
| 125W5 | 125 | 5 | 0,5 | 1 | 4 | 130 | 225 | 200 | 175 | 8 | 290 | 158 | 375 | 65 | 265 | 145 | 65 | 150 | 14 | 88 | 65 | 57 | 43 |
| 125W8 | 125 | 8 | 0,5 | 1 | 4 | 130 | 225 | 200 | 175 | 8 | 290 | 158 | 375 | 65 | 265 | 145 | 65 | 150 | 14 | 88 | 65 | 57 | 43 |
| 125W12 | 125 | 14 | 1 | 1 | 4 | 130 | 225 | 200 | 175 | 8 | 290 | 158 | 375 | 65 | 265 | 145 | 65 | 150 | 14 | 88 | 65 | 59 | 45 |
| 125W14 | 125 | 1-4 | 0,2-0,5 | 1 | 4 | 130 | 225 | 200 | 175 | 8 | 290 | 158 | 375 | 65 | 265 | 145 | 65 | 150 | 14 | 88 | 65 | 57 | 43 |
| 125W28 | 125 | 2-8 | 0,2-0,5 | 1 | 4 | 130 | 225 | 200 | 175 | 8 | 290 | 158 | 375 | 65 | 265 | 145 | 65 | 150 | 14 | 88 | 65 | 59 | 45 |
| 125W312 | 125 | 3,5-14 | 0,2-0,5 | 1 | 4 | 130 | 225 | 200 | 175 | 8 | 290 | 158 | 375 | 65 | 265 | 145 | 65 | 150 | 14 | 88 | 65 | 59 | 45 |
| 250W5 | 250 | 5 | 0,5 | 1 | 4 | 130 | 225 | 200 | 175 | 8 | 290 | 158 | 375 | 65 | 265 | 145 | 65 | 150 | 14 | 88 | 65 | 57 | 43 |
| 250W8 | 250 | 8 | 0,8 | 1 | 4 | 130 | 225 | 200 | 175 | 8 | 290 | 158 | 375 | 65 | 265 | 145 | 65 | 150 | 14 | 88 | 65 | 57 | 43 |
| 250W12 | 250 | 12 | 1 | 1 | 5 | 130 | 225 | 200 | 175 | 8 | 290 | 158 | 375 | 65 | 265 | 145 | 65 | 150 | 14 | 88 | 65 | 59 | 45 |
| 250W16 | 250 | 16 | 1 | 1 | 5 | 130 | 225 | 200 | 175 | 8 | 290 | 158 | 375 | 65 | 265 | 145 | 65 | 150 | 14 | 88 | 65 | 59 | 45 |
| 250W14 | 250 | 1-4 | 0,2-0,5 | 1 | 4 | 130 | 225 | 200 | 175 | 8 | 290 | 158 | 375 | 65 | 265 | 145 | 65 | 150 | 14 | 88 | 65 | 57 | 43 |
| 250W28 | 250 | 2-8 | 0,25-1 | 1 | 4 | 130 | 235 | 200 | 185 | 8 | 290 | 158 | 385 | 65 | 265 | 145 | 65 | 150 | 14 | 88 | 65 | 59 | 45 |
| 250W312 | 250 | 3-12 | 0,25-1 | 1 | 5 | 130 | 235 | 200 | 185 | 8 | 290 | 158 | 385 | 65 | 265 | 145 | 65 | 150 | 14 | 88 | 65 | 65 | 51 |
| 500W4 | 500 | 4 | 0,8 | 1 | 5 | 130 | 225 | 200 | 175 | 8 | 290 | 158 | 390 | 65 | 265 | 145 | 65 | 150 | 14 | 88 | 65 | 59 | 45 |
| 500W6 | 500 | 6 | 0,8 | 1 | 5 | 130 | 225 | 200 | 175 | 8 | 290 | 158 | 390 | 65 | 265 | 145 | 65 | 150 | 14 | 88 | 65 | 59 | 45 |
| 500W8 | 500 | 8 | 1 | 1 | 5 | 130 | 235 | 200 | 185 | 8 | 290 | 158 | 400 | 65 | 265 | 145 | 65 | 150 | 14 | 88 | 65 | 65 | 51 |
| 500W12 | 500 | 12 | 1,5 | 1 | 5 | 116 | 235 | 200 | 185 | 8 | 290 | 158 | 400 | 65 | 265 | 145 | 65 | 150 | 14 | 88 | 65 | 65 | 51 |
| 500W14 | 500 | 1-4 | 0,25-1 | 1 | 5 | 116 | 235 | 200 | 185 | 8 | 290 | 158 | 400 | 65 | 265 | 145 | 65 | 150 | 14 | 88 | 65 | 65 | 51 |
| 500W28 | 500 | 2-8 | 0,4-1,8 | 1 | 7 | 116 | 260 | 230 | 200 | 12 | 290 | 162 | 405 | 73 | 265 | 145 | 70 | 200 | 18 | 90 | 70 | 74 | 60 |
| 1000W4 | 1000 | 4 | 1 | 1 | 7 | 116 | 240 | 230 | 190 | 12 | 290 | 162 | 430 | 73 | 265 | 145 | 70 | 200 | 18 | 90 | 70 | 71 | 57 |
| 1000W6 | 1000 | 6 | 1,6 | 1 | 7 | 116 | 260 | 230 | 200 | 12 | 290 | 162 | 440 | 73 | 265 | 145 | 70 | 200 | 18 | 90 | 70 | 74 | 60 |
| 1000W14 | 1000 | 1-4 | 0,4-1,8 | 1 | 7 | 116 | 260 | 230 | 200 | 12 | 290 | 162 | 440 | 73 | 268 | 145 | 70 | 200 | 18 | 90 | 70 | 74 | 61 |
| 1000W8 | 1000 | 8 | 2 | 1 | 10 | 185 | 275 | 235 | 245 | 15 | 290 | 162 | 505 | 92 | 268 | 148 | 70 | 320 | 22 | 90 | 70 | 98 | 86 |
| 1000W28 | 1000 | 2-8 | 0,5-2 | 1 | 10 | 185 | 290 | 235 | 245 | 15 | 290 | 162 | 505 | 92 | 268 | 148 | 70 | 320 | 22 | 90 | 70 | 102 | 88 |
| 1500W4 | 1500 | 4 | 2 | 2 | 10 | 185 | 275 | 235 | 245 | 15 | 290 | 162 | 595 | 92 | 268 | 148 | 70 | 320 | 22 | 90 | 70 | 114 | 103 |
| 1500W14 | 1500 | 1-4 | 0,5-2 | 2 | 10 | 185 | 290 | 235 | 245 | 15 | 290 | 162 | 595 | 92 | 268 | 148 | 70 | 320 | 22 | 90 | 70 | 117 | 107 |
| 2000W4 | 2000 | 4 | 2 | 2 | 10 | 185 | 275 | 235 | 245 | 15 | 290 | 162 | 595 | 92 | 268 | 148 | 70 | 200 | 22 | 90 | 70 | 114 | 103 |
| 2000W14 | 2000 | 1-4 | 0,5-2 | 2 | 10 | 185 | 290 | 235 | 245 | 15 | 290 | 162 | 595 | | | | | | | | | | |

W Serie - Type F

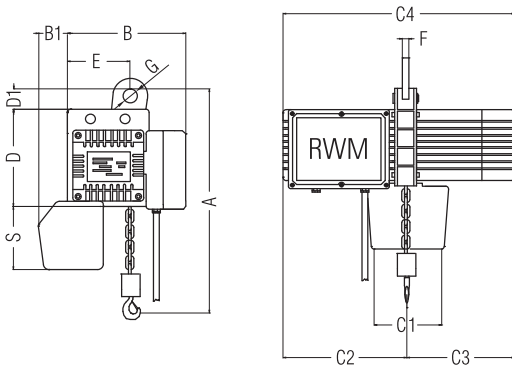

W Serie - Type CS

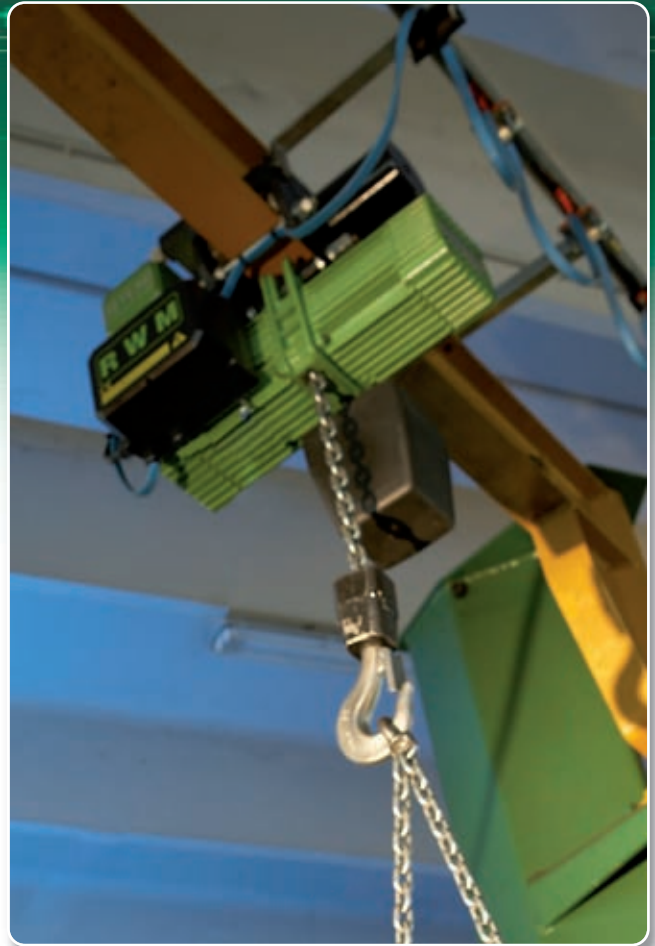
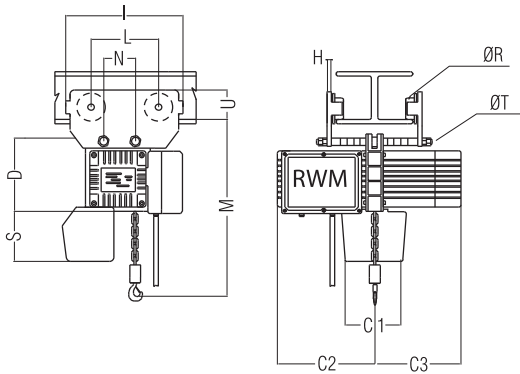

W Serie - Type CE

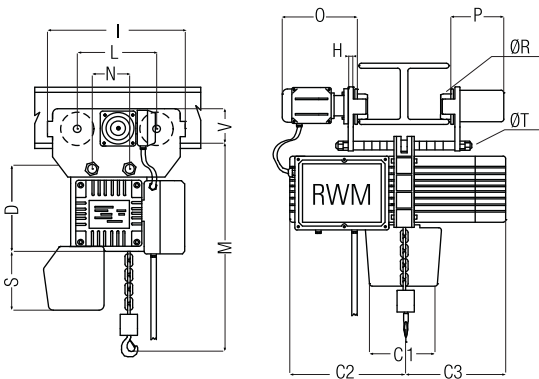

W Serie - Type CM

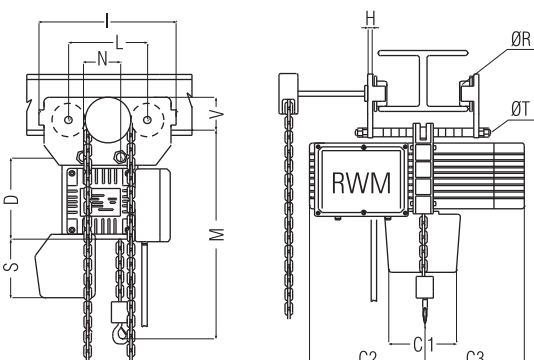

models **W Series**



Type F



Type CS



Type CE



Type CM

WR Series

electric chain hoists



WR series hoists are designed to lift loads from 1000 kg to 5000 kg in a production environment with a high duty cycle and proven reliability. The hoist body is completely manufactured completely from aluminium and steel with no plastic components. With the new design RWM have produced a hoist with the minimum low headroom and at the same time safe and reliable with particular attention to the selection and test of materials used.

Electric motor

The three phase motor is produced with single or double windings for single or dual speeds. The insulation is class F for both motors. Manufactured to FEM standard 2m, the WR hoists have a duty of 55% on single speed hoists and 15+40% on dual speed hoists. Standard operating voltage's 230/400V, 3 phase, 50 Hz, other voltages available on request.

Hoist motor protected to IP 55 against ingress of dust and water, upgradeable to IP 65 upon request. The hoists 3000/4000/5000 have a standard fan assisted motor for better cooling and increased duty cycles.

Reduction gear

The reduction gears are designed in such a way that the speed of the hoist can be changed simply by increasing or decreasing the number of components in the gearbox.

The gears are manufactured from high tensile steel and are hardened and heat treated to give maximum life. With the correct choice of oil the hoist can work within the following temperature range, -20°C to +60°C.

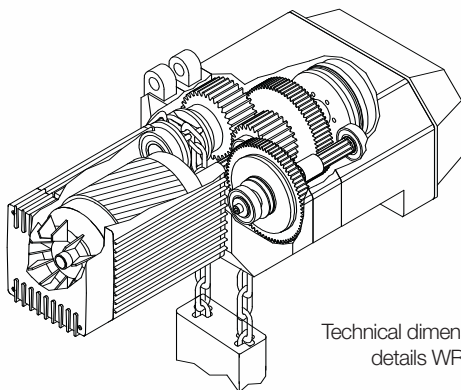

Technical dimensional details WR serie

RWM WR series hoists are supplied with **upper and lower electric limit switches** to prevent hook over travel and prevent the use the clutch as an ultimate limit and extending the life of the clutch and gearbox

They are manufactured with two micro switches that operate on the auxiliary circuit of the hoist contactors cutting out operating contactor in the direction of lift.

The hoists are also equipped with a slipping clutch that is set to 120% of the working load limit to prevent accidental overloading.

All hoists are manufactured to CEI EN60204 governing the safety of electrical equipment with low voltage controls 24v, via a transformer mounted in a steel enclosure within the hoist body.

Due to the high quality of electrical contactors used and the 400 vac brake RWM guarantee the WR series hoists for more than 240 operations per hour.



Type F dimensions and technical specifications

| Model | Capacity kg | Speed m/min. | Kw | Pull of chain | Ø chain | A | B1 | B2 | B3 | B4 | B5 | Ø hole | C2 | C3 | C4 | D | I3 | I4 | S | S1 | G | V | Weight kg |
|-----------|-------------|--------------|---------|---------------|---------|-----|-----|----|----|-----|-----|--------|-----|-----|-----|-----|-----|-----|-----|-----|----|-----|-----------|
| 1000WR8 | 1000 | 8 | 2 | 1 | 10 | 440 | 127 | 73 | / | 273 | 70 | 40 | 345 | 310 | 655 | 168 | 216 | 127 | 290 | 235 | 25 | 168 | 78 |
| 1000WR12 | 1000 | 12 | 3 | 1 | 10 | 605 | 125 | 54 | 54 | 350 | 85 | 40 | 320 | 300 | 620 | 235 | 220 | 235 | 330 | 300 | 25 | 162 | 98 |
| 1000WR28 | 1000 | 2-8 | 0,5-2 | 1 | 10 | 440 | 127 | 73 | / | 273 | 70 | 40 | 345 | 310 | 655 | 168 | 216 | 127 | 290 | 235 | 25 | 168 | 80 |
| 1000WR312 | 1000 | 3-12 | 0,7-3 | 1 | 10 | 565 | 125 | 54 | 54 | 350 | 85 | 40 | 320 | 300 | 620 | 235 | 220 | 235 | 330 | 300 | 25 | 162 | 83 |
| 1500WR4 | 1500 | 4 | 2 | 1 | 10 | 466 | 127 | 73 | / | 273 | 70 | 40 | 345 | 310 | 655 | 168 | 216 | 127 | 290 | 235 | 25 | 168 | 90 |
| 1500WR8 | 1500 | 8 | 3 | 1 | 10 | 605 | 125 | 54 | 54 | 350 | 85 | 40 | 320 | 300 | 620 | 235 | 220 | 235 | 330 | 300 | 25 | 162 | 98 |
| 1500WR12 | 1500 | 12 | 3 | 1 | 10 | 605 | 125 | 54 | 54 | 350 | 85 | 40 | 320 | 300 | 620 | 235 | 220 | 235 | 330 | 300 | 25 | 162 | 98 |
| 1500WR14 | 1500 | 1-4 | 0,5-2 | 1 | 10 | 466 | 127 | 73 | / | 273 | 70 | 40 | 345 | 310 | 655 | 168 | 216 | 127 | 330 | 235 | 25 | 168 | 90 |
| 1500WR28 | 1500 | 2-8 | 0,7-3 | 1 | 10 | 605 | 125 | 54 | 54 | 350 | 85 | 40 | 350 | 300 | 650 | 235 | 220 | 235 | 290 | 300 | 25 | 162 | 105 |
| 1500WR312 | 1500 | 3-12 | 0,7-3 | 1 | 11 | 605 | 125 | 54 | 54 | 350 | 85 | 40 | 350 | 330 | 680 | 235 | 220 | 235 | 330 | 300 | 25 | 162 | 98 |
| 2000WR4 | 2000 | 4 | 2 | 1 | 10 | 466 | 127 | 73 | / | 273 | 70 | 40 | 345 | 310 | 655 | 168 | 216 | 127 | 290 | 235 | 25 | 168 | 90 |
| 2000WR8 | 2000 | 8 | 3 | 1 | 11 | 605 | 125 | 54 | 54 | 350 | 85 | 40 | 320 | 330 | 650 | 235 | 220 | 235 | 330 | 300 | 25 | 162 | 105 |
| 2000WR14 | 2000 | 1-4 | 0,5-2 | 1 | 10 | 466 | 127 | 73 | / | 273 | 70 | 40 | 345 | 310 | 655 | 168 | 216 | 127 | 290 | 235 | 25 | 168 | 90 |
| 2000WR28 | 2000 | 2-8 | 0,7-3 | 1 | 11 | 605 | 125 | 54 | 54 | 350 | 85 | 40 | 350 | 330 | 680 | 235 | 220 | 235 | 330 | 300 | 25 | 162 | 98 |
| 2500WR8 | 2500 | 8 | 3 | 1 | 11 | 605 | 125 | 54 | 54 | 350 | 85 | 40 | 320 | 330 | 650 | 235 | 220 | 235 | 330 | 300 | 25 | 162 | 98 |
| 2500WR28 | 2500 | 2-8 | 0,8-3,5 | 1 | 11 | 605 | 125 | 54 | 54 | 350 | 85 | 40 | 350 | 330 | 680 | 235 | 220 | 235 | 330 | 300 | 25 | 162 | 98 |
| 3200WR4 | 3200 | 4 | 3 | 2 | 10 | 670 | 125 | 54 | 54 | 350 | 85 | 40 | 320 | 300 | 620 | 235 | 270 | 185 | 330 | 300 | 25 | 162 | 103 |
| 3200WR14 | 3200 | 1-4 | 0,7-3 | 2 | 10 | 670 | 125 | 54 | 54 | 350 | 85 | 40 | 350 | 330 | 680 | 235 | 270 | 185 | 330 | 300 | 25 | 162 | 113 |
| 4000WR4 | 4000 | 4 | 3 | 2 | 11 | 685 | 125 | 54 | 54 | 350 | 110 | 40 | 320 | 330 | 650 | 235 | 320 | 185 | 390 | 300 | 25 | 162 | 113 |
| 4000WR14 | 4000 | 1-4 | 0,7-3 | 2 | 11 | 685 | 125 | 54 | 54 | 350 | 110 | 40 | 350 | 330 | 680 | 235 | 320 | 185 | 390 | 300 | 25 | 162 | 118 |
| 5000WR4 | 5000 | 4 | 3 | 2 | 11 | 685 | 125 | 54 | 54 | 350 | 110 | 40 | 320 | 330 | 650 | 235 | 320 | 185 | 390 | 300 | 25 | 162 | 123 |
| 5000WR14 | 5000 | 1-4 | 0,8-3,5 | 2 | 11 | 685 | 125 | 54 | 54 | 350 | 110 | 40 | 350 | 330 | 680 | 235 | 320 | 185 | 390 | 300 | 25 | 162 | 123 |

Type CS dimensions and technical specifications

| Model | Capacity kg | Speed m/min. | Kw | Pull of chain | Ø chain | C2 | C3 | D | I1 | I2 | I3 | I4 | L | M | M1 | S | S1 | S2 | V | V1 | Ø wheel | Weight kg |
|-----------|-------------|--------------|---------|---------------|---------|-----|-----|-----|-----|-----|-----|-----|-----|-----|----|-----|-----|-----|-----|-----|---------|-----------|
| 1000WR8 | 1000 | 8 | 2 | 1 | 10 | 345 | 310 | 168 | 188 | 107 | 216 | 127 | 162 | 500 | 90 | 290 | 235 | 141 | 168 | 195 | 70 | 93 |
| 1000WR12 | 1000 | 12 | 3 | 1 | 10 | 320 | 330 | 235 | 150 | 170 | 220 | 235 | 176 | 655 | 95 | 330 | 300 | 165 | 162 | 223 | 80 | 120 |
| 1000WR28 | 1000 | 2-8 | 0,5-2 | 1 | 10 | 345 | 310 | 168 | 188 | 107 | 216 | 127 | 162 | 500 | 90 | 290 | 235 | 141 | 168 | 195 | 70 | 95 |
| 1000WR312 | 1000 | 3-12 | 0,7-3 | 1 | 10 | 320 | 300 | 235 | 150 | 170 | 220 | 235 | 176 | 615 | 95 | 330 | 300 | 165 | 162 | 223 | 80 | 98 |
| 1500WR4 | 1500 | 4 | 2 | 1 | 10 | 345 | 310 | 168 | 188 | 107 | 216 | 127 | 162 | 526 | 90 | 290 | 235 | 141 | 168 | 195 | 70 | 105 |
| 1500WR8 | 1500 | 8 | 3 | 1 | 10 | 320 | 300 | 235 | 150 | 170 | 220 | 235 | 176 | 655 | 95 | 330 | 300 | 165 | 162 | 223 | 80 | 120 |
| 1500WR12 | 1500 | 12 | 3 | 1 | 10 | 320 | 330 | 235 | 150 | 170 | 220 | 235 | 176 | 655 | 95 | 330 | 300 | 165 | 162 | 223 | 80 | 120 |
| 1500WR14 | 1500 | 1-4 | 0,5-2 | 1 | 10 | 345 | 310 | 168 | 188 | 107 | 216 | 127 | 162 | 526 | 90 | 290 | 235 | 141 | 168 | 195 | 70 | 105 |
| 1500WR28 | 1500 | 2-8 | 0,7-3 | 1 | 10 | 350 | 300 | 235 | 150 | 170 | 220 | 235 | 176 | 655 | 95 | 330 | 300 | 165 | 162 | 223 | 80 | 120 |
| 1500WR312 | 1500 | 3-12 | 0,7-3 | 1 | 11 | 350 | 330 | 235 | 150 | 170 | 220 | 235 | 176 | 655 | 95 | 330 | 300 | 165 | 162 | 223 | 80 | 120 |
| 2000WR4 | 2000 | 4 | 2 | 1 | 10 | 345 | 310 | 168 | 188 | 107 | 216 | 127 | 162 | 526 | 90 | 290 | 235 | 141 | 168 | 195 | 70 | 105 |
| 2000WR8 | 2000 | 8 | 3 | 1 | 11 | 320 | 330 | 235 | 150 | 170 | 220 | 235 | 176 | 655 | 95 | 330 | 300 | 165 | 162 | 223 | 80 | 120 |
| 2000WR14 | 2000 | 1-4 | 0,5-2 | 1 | 10 | 345 | 310 | 168 | 188 | 107 | 216 | 127 | 162 | 526 | 90 | 290 | 235 | 141 | 162 | 195 | 70 | 105 |
| 2000WR28 | 2000 | 2-8 | 0,7-3 | 1 | 11 | 350 | 330 | 235 | 150 | 170 | 220 | 235 | 176 | 655 | 95 | 330 | 300 | 165 | 162 | 223 | 80 | 125 |
| 2500WR8 | 2500 | 8 | 3 | 1 | 11 | 320 | 330 | 235 | 150 | 170 | 220 | 235 | 176 | 655 | 95 | 330 | 300 | 165 | 162 | 223 | 80 | 115 |
| 2500WR28 | 2500 | 2-8 | 0,8-3,5 | 1 | 11 | 350 | 330 | 235 | 150 | 170 | 220 | 235 | 176 | 655 | 95 | 330 | 300 | 165 | 162 | 223 | 80 | 125 |
| 3200WR4 | 3200 | 4 | 3 | 2 | 10 | 320 | 300 | 235 | 150 | 170 | 270 | 185 | 176 | 717 | 95 | 330 | 300 | 165 | 162 | 223 | 80 | 125 |
| 3200WR14 | 3200 | 1-4 | 0,7-3 | 2 | 10 | 350 | 330 | 235 | 150 | 170 | 270 | 185 | 176 | 717 | 95 | 330 | 300 | 165 | 162 | 223 | 80 | 135 |
| 4000WR4 | 4000 | 4 | 3 | 2 | 11 | 320 | 330 | 235 | 150 | 170 | 320 | 185 | 176 | 735 | 95 | 390 | 300 | 165 | 162 | 223 | 80 | 135 |
| 4000WR14 | 4000 | 1-4 | 0,7-3 | 2 | 11 | 350 | 330 | 235 | 150 | 170 | 320 | 185 | 176 | 735 | 95 | 390 | 300 | 165 | 162 | 223 | 80 | 140 |
| 5000WR4 | 5000 | 4 | 3 | 2 | 11 | 320 | 330 | 235 | 150 | 170 | 320 | 185 | 176 | 735 | 95 | 390 | 300 | 165 | 162 | 223 | 80 | 145 |
| 5000WR14 | 5000 | 1-4 | 0,8-3,5 | 2 | 11 | 350 | 330 | 235 | 150 | 170 | 320 | 185 | 176 | 735 | 95 | 390 | 300 | 165 | 162 | 223 | 80 | 145 |

Type CE dimensions and technical specifications

| Model | Capacity kg | Speed m/min. | Kw | Pull of chain | Ø chain | C2 | C3 | D | I1 | I2 | I3 | I4 | L | M | M1 | P | S | S1 | S2 | V | V1 | Z | Ø wheel | Weight kg |
|-----------|-------------|--------------|---------|---------------|---------|-----|-----|-----|-----|-----|-----|-----|-----|-----|----|-----|-----|-----|-----|-----|-----|-----|---------|-----------|
| 1000WR8 | 1000 | 8 | 2 | 1 | 10 | 345 | 310 | 168 | 188 | 107 | 220 | 235 | 162 | 500 | 90 | 268 | 290 | 235 | 141 | 168 | 195 | 710 | 70 | 110 |
| 1000WR12 | 1000 | 12 | 3 | 1 | 10 | 320 | 330 | 235 | 150 | 170 | 220 | 235 | 176 | 655 | 95 | 310 | 330 | 300 | 165 | 162 | 223 | 710 | 80 | 130 |
| 1000WR28 | 1000 | 2-8 | 0,5-2 | 1 | 10 | 345 | 310 | 168 | 188 | 107 | 220 | 235 | 162 | 500 | 90 | 268 | 290 | 235 | 141 | 168 | 195 | 710 | 70 | 110 |
| 1000WR312 | 1000 | 3-12 | 0,7-3 | 1 | 10 | 320 | 300 | 235 | 150 | 170 | 220 | 235 | 176 | 615 | 95 | 310 | 330 | 300 | 165 | 162 | 223 | 710 | 80 | 130 |
| 1500WR4 | 1500 | 4 | 2 | 1 | 10 | 345 | 310 | 168 | 188 | 107 | 220 | 235 | 162 | 526 | 90 | 268 | 290 | 235 | 141 | 168 | 195 | 710 | 70 | 115 |
| 1500WR8 | 1500 | 8 | 3 | 1 | 10 | 320 | 300 | 235 | 150 | 170 | 220 | 235 | 176 | 655 | 95 | 310 | 330 | 300 | 165 | 162 | 223 | 710 | 80 | 130 |
| 1500WR12 | 1500 | 12 | 3 | 1 | 10 | 320 | 330 | 235 | 150 | 170 | 220 | 235 | 176 | 655 | 95 | 310 | 330 | 300 | 165 | 162 | 223 | 710 | 80 | 130 |
| 1500WR14 | 1500 | 1-4 | 0,5-2 | 1 | 10 | 345 | 310 | 168 | 188 | 107 | 220 | 235 | 162 | 526 | 90 | 268 | 290 | 235 | 141 | 168 | 195 | 710 | 70 | 115 |
| 1500WR28 | 1500 | 2-8 | 0,7-3 | 1 | 10 | 350 | 300 | 235 | 150 | 170 | 220 | 235 | 176 | 655 | 95 | 310 | 330 | 300 | 165 | 162 | 223 | 710 | 80 | 130 |
| 1500WR312 | 1500 | 3-12 | 0,7-3 | 1 | 11 | 350 | 330 | 235 | 150 | 170 | 220 | 235 | 176 | 655 | 95 | 310 | 330 | 300 | 165 | 162 | 223 | 710 | 80 | 130 |
| 2000WR4 | 2000 | 4 | 2 | 1 | 10 | 345 | 310 | 168 | 188 | 107 | 220 | 235 | 162 | 526 | 90 | 268 | 290 | 235 | 141 | 168 | 195 | 710 | 70 | 115 |
| 2000WR8 | 2000 | 8 | 3 | 1 | 11 | 320 | 330 | 235 | 150 | 170 | 220 | 235 | 176 | 655 | 95 | 310 | 330 | 300 | 165 | 162 | 223 | 710 | 80 | 130 |
| 2000WR14 | 2000 | 1-4 | 0,5-2 | 1 | 10 | 345 | 310 | 168 | 188 | 107 | 220 | 235 | 162 | 685 | 90 | 268 | 290 | 235 | 141 | 223 | 195 | 134 | 70 | 115 |
| 2000WR28 | 2000 | 2-8 | 0,7-3 | 1 | 11 | 350 | 330 | 235 | 150 | 170 | 220 | 235 | 176 | 655 | 95 | 310 | 330 | 300 | 165 | 162 | 223 | 710 | 80 | 134 |
| 2500WR8 | 2500 | 8 | 3 | 1 | 11 | 320 | 330 | 235 | 150 | 170 | 220 | 235 | 176 | 655 | 95 | 310 | 330 | 300 | 165 | 162 | 223 | 710 | 80 | 134 |
| 2500WR28 | 2500 | 2-8 | 0,8-3,5 | 1 | 11 | 350 | 330 | 235 | 150 | 170 | 220 | 235 | 176 | 655 | 95 | 310 | 330 | | | | | | | |

Type F dimensions

WR 2000 - Type F

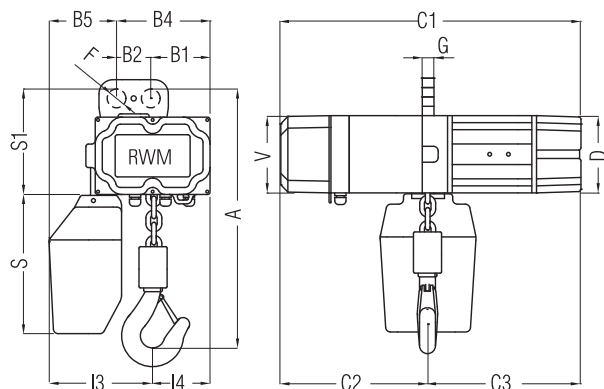

WR 3000/4000/5000 - Type F

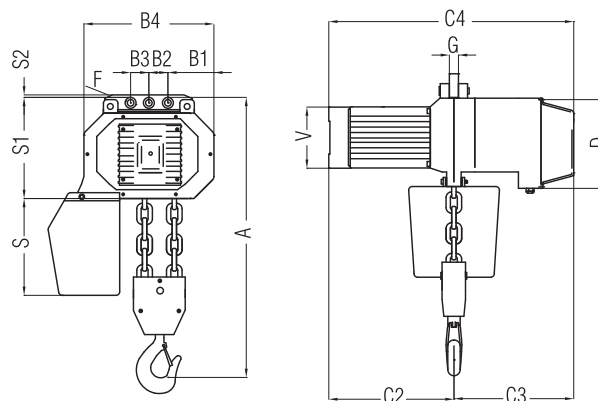

Type CS dimensions

WR 2000 - Type CS

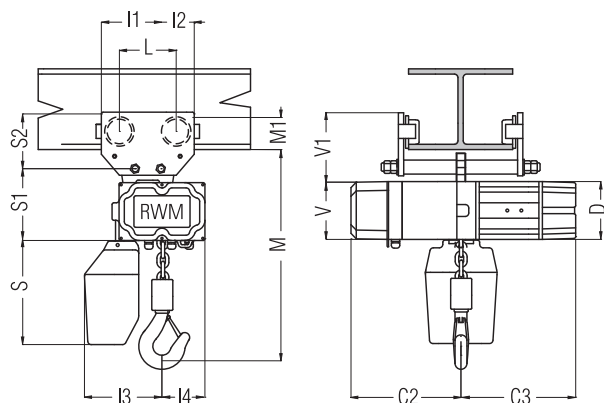

WR 3000/4000/5000 - Type CS

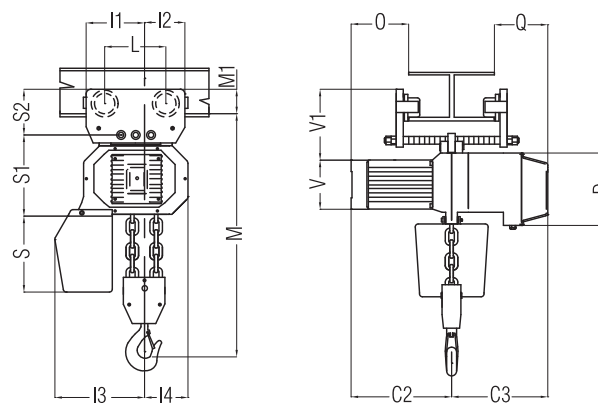

Type CE dimensions

WR 2000 - Type CE

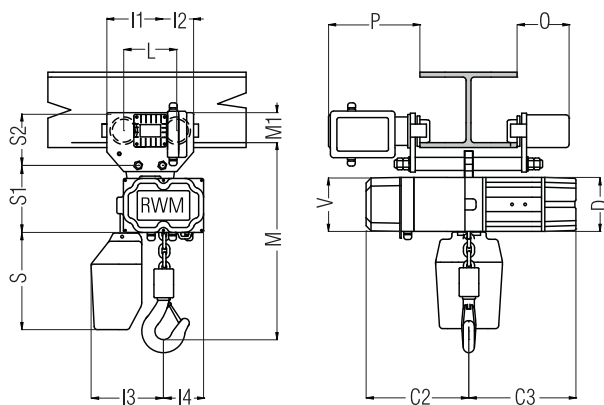

WR 3000/4000/5000 - Type CE

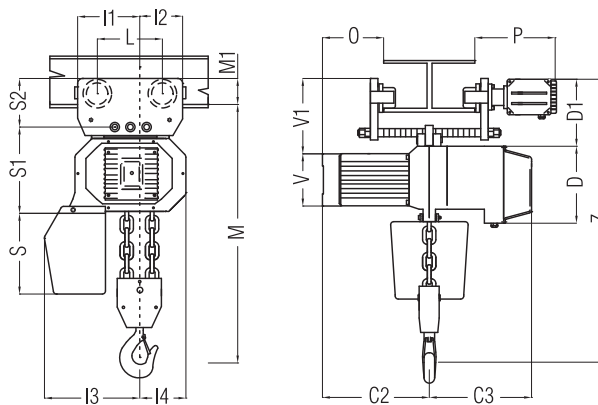

models **WR Series**



Type F



Type CS



Type CE

Low headroom series electric chain hoists

The low headroom trolleys are used when it is necessary to have the maximum utility height between the floor and the beam. It is important when we have buildings with low height or when it is necessary to enter in compact spaces.



Low headroom = more utility height

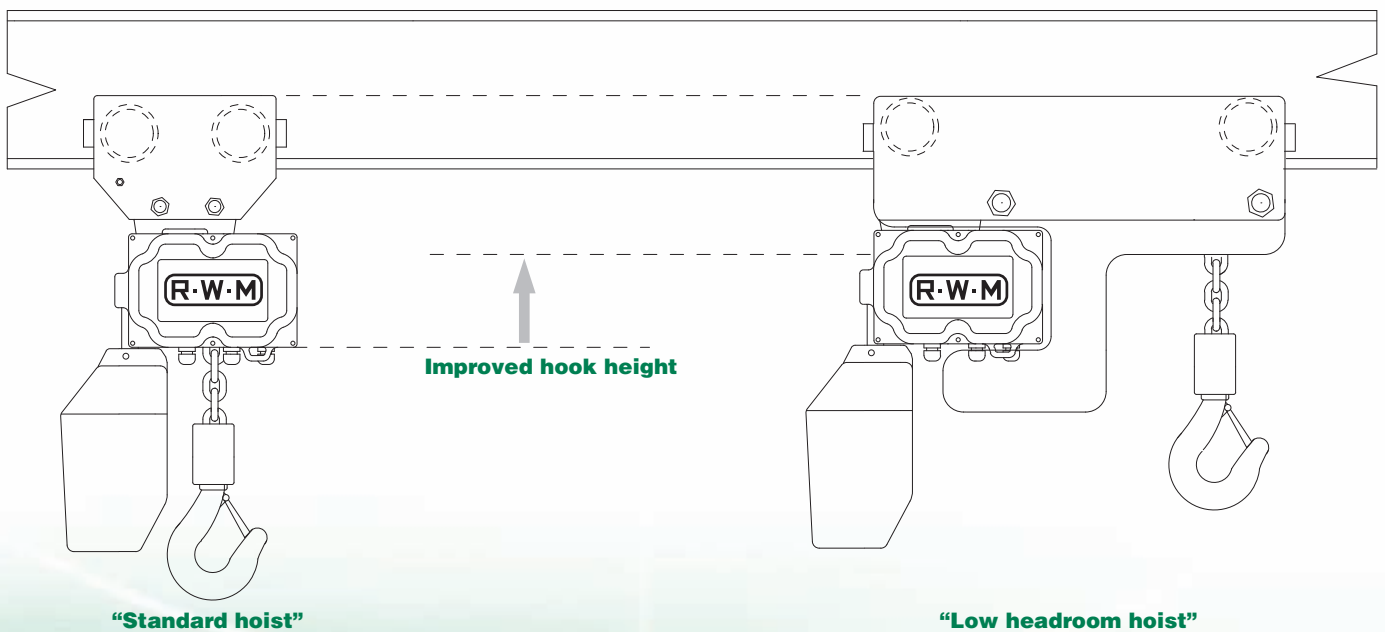

Also in those hoists the principal structure is made from steel plates and electric limit switch to stop the trolley long the beam. The hoist is put to the end of the trolley to reduce the hook respect the beam.

Apply to the W and WR serie, the low headroom trolley is made with one motor with capacity until 1000 kg and with a double motor for capacity from 2000 kg to 5000kg. For special applications those trolleys can be made longer as measure so that the hook can be more free from obstructions.

Type CS-CE

dimensions and technical specifications

| Modello | Capacity kg | Speed m/min. | Kw | Pull of chain | Ø chain | A | B | C1 | C2 | C3 | E | F | H | | I | L | N | O | P | R | | T | V | Weight kg | |
|----------|-------------|--------------|---------|---------------|---------|-----|-----|-----|-----|-----|-----|-----|----|----|-----|-----|-----|-----|-----|----|----|----|-----|-----------|-----|
| | | | | | | | | | | | | | CE | CS | | | | | | CE | CS | | | CE | CS |
| 125W5 | 125 | 5 | 0,5 | 1 | 4 | 195 | 150 | 130 | 225 | 200 | 230 | 265 | 12 | 8 | 370 | 270 | 240 | 100 | 90 | 65 | 50 | 14 | 65 | 61 | 47 |
| 125W8 | 125 | 8 | 0,5 | 1 | 4 | 195 | 150 | 130 | 225 | 200 | 230 | 265 | 12 | 8 | 370 | 270 | 240 | 100 | 90 | 65 | 50 | 14 | 65 | 61 | 47 |
| 125W12 | 125 | 14 | 1 | 1 | 4 | 195 | 150 | 130 | 225 | 200 | 230 | 265 | 12 | 8 | 370 | 270 | 240 | 100 | 90 | 65 | 50 | 14 | 65 | 61 | 47 |
| 125W14 | 125 | 1-4 | 0,2-0,5 | 1 | 4 | 195 | 150 | 130 | 225 | 200 | 230 | 265 | 12 | 8 | 370 | 270 | 240 | 100 | 90 | 65 | 50 | 14 | 65 | 61 | 47 |
| 125W28 | 125 | 2-8 | 0,2-0,5 | 1 | 4 | 195 | 150 | 130 | 225 | 200 | 230 | 265 | 12 | 8 | 370 | 270 | 240 | 100 | 90 | 65 | 50 | 14 | 65 | 61 | 47 |
| 250W5 | 250 | 5 | 0,5 | 1 | 4 | 195 | 150 | 130 | 225 | 200 | 230 | 265 | 12 | 8 | 370 | 270 | 240 | 100 | 90 | 65 | 50 | 14 | 65 | 61 | 47 |
| 250W8 | 250 | 8 | 0,8 | 1 | 4 | 195 | 150 | 130 | 225 | 200 | 230 | 265 | 12 | 8 | 370 | 270 | 240 | 100 | 90 | 65 | 50 | 14 | 65 | 63 | 49 |
| 250W14 | 250 | 1-4 | 0,2-0,5 | 1 | 4 | 195 | 150 | 130 | 225 | 200 | 230 | 265 | 12 | 8 | 370 | 270 | 240 | 100 | 90 | 65 | 50 | 14 | 65 | 63 | 49 |
| 250W28 | 250 | 2-8 | 0,25-1 | 1 | 4 | 205 | 150 | 130 | 235 | 200 | 230 | 265 | 12 | 8 | 370 | 270 | 240 | 100 | 90 | 65 | 50 | 14 | 65 | 63 | 49 |
| 500W4 | 500 | 4 | 0,8 | 1 | 5 | 195 | 150 | 130 | 225 | 200 | 250 | 265 | 12 | 8 | 370 | 270 | 240 | 100 | 90 | 65 | 50 | 14 | 65 | 63 | 49 |
| 500W6 | 500 | 6 | 0,8 | 1 | 5 | 195 | 150 | 130 | 225 | 200 | 250 | 265 | 12 | 8 | 370 | 270 | 240 | 100 | 90 | 65 | 50 | 14 | 65 | 63 | 49 |
| 500W8 | 500 | 8 | 1 | 1 | 5 | 205 | 150 | 130 | 235 | 200 | 250 | 265 | 12 | 8 | 370 | 270 | 240 | 100 | 90 | 65 | 50 | 14 | 65 | 66 | 52 |
| 500W14 | 500 | 1-4 | 0,25-1 | 1 | 5 | 205 | 150 | 116 | 235 | 200 | 250 | 265 | 12 | 8 | 370 | 270 | 240 | 100 | 90 | 65 | 50 | 14 | 65 | 66 | 52 |
| 500W28 | 500 | 2-8 | 0,4-1,8 | 1 | 7 | 220 | 200 | 116 | 260 | 230 | 330 | 265 | 12 | 12 | 520 | 400 | 295 | 160 | 100 | 70 | 70 | 18 | 94 | 89 | 77 |
| 1000W4 | 1000 | 4 | 1 | 1 | 7 | 210 | 200 | 116 | 240 | 230 | 330 | 265 | 12 | 12 | 520 | 400 | 295 | 160 | 100 | 70 | 70 | 18 | 94 | 86 | 74 |
| 1000W6 | 1000 | 6 | 1,6 | 1 | 7 | 220 | 200 | 116 | 260 | 230 | 330 | 265 | 12 | 12 | 520 | 400 | 295 | 160 | 100 | 70 | 70 | 18 | 94 | 89 | 77 |
| 1000W14 | 1000 | 1-4 | 0,4-1,8 | 1 | 7 | 220 | 200 | 116 | 260 | 230 | 330 | 265 | 12 | 12 | 520 | 400 | 295 | 160 | 100 | 70 | 70 | 18 | 94 | 89 | 77 |
| 1000W8 | 1000 | 8 | 2 | 1 | 10 | 265 | 290 | 210 | 345 | 310 | 350 | 268 | 15 | 15 | 598 | 492 | 436 | 158 | 102 | 80 | 80 | 24 | 94 | 126 | 118 |
| 1000WR28 | 1000 | 2-8 | 0,5-2 | 1 | 10 | 265 | 330 | 210 | 345 | 310 | 350 | 268 | 15 | 15 | 598 | 492 | 436 | 158 | 102 | 80 | 80 | 24 | 94 | 126 | 118 |
| 1500W4 | 1500 | 4 | 2 | 1 | 10 | 265 | 290 | 210 | 345 | 310 | 375 | 268 | 15 | 15 | 598 | 492 | 436 | 158 | 102 | 70 | 70 | 24 | 94 | 126 | 118 |
| 1500W8 | 1500 | 8 | 3 | 1 | 10 | 350 | 330 | 210 | 320 | 300 | 375 | 268 | 15 | 15 | 817 | 673 | 445 | 255 | 135 | 80 | 80 | 24 | 100 | 138 | 125 |
| 1500WR14 | 1500 | 1-4 | 0,5-2 | 1 | 10 | 265 | 290 | 210 | 345 | 310 | 375 | 268 | 15 | 15 | 598 | 492 | 436 | 158 | 102 | 70 | 70 | 24 | 94 | 126 | 118 |
| 1500WR28 | 1500 | 2-8 | 0,7-3 | 1 | 10 | 350 | 330 | 210 | 350 | 300 | 375 | 268 | 15 | 15 | 817 | 673 | 445 | 255 | 135 | 80 | 80 | 24 | 100 | 138 | 125 |
| 2000W4 | 2000 | 4 | 2 | 1 | 10 | 265 | 330 | 210 | 345 | 310 | 375 | 268 | 15 | 15 | 598 | 492 | 436 | 158 | 102 | 70 | 70 | 24 | 94 | 126 | 118 |
| 2000W8 | 2000 | 8 | 3 | 1 | 11 | 350 | 330 | 210 | 320 | 330 | 375 | 268 | 15 | 15 | 817 | 673 | 445 | 255 | 135 | 80 | 80 | 24 | 100 | 138 | 125 |
| 2000WR14 | 2000 | 1-4 | 0,5-2 | 1 | 10 | 265 | 290 | 210 | 345 | 310 | 375 | 268 | 15 | 15 | 598 | 492 | 436 | 158 | 102 | 70 | 70 | 24 | 94 | 126 | 118 |
| 2000WR28 | 2000 | 2-8 | 0,7-3 | 1 | 11 | 350 | 330 | 210 | 350 | 330 | 375 | 268 | 15 | 15 | 817 | 673 | 445 | 255 | 135 | 80 | 80 | 24 | 100 | 138 | 125 |
| 2500W8 | 2500 | 8 | 3 | 1 | 11 | 350 | 330 | 210 | 320 | 330 | 395 | 310 | 15 | 15 | 817 | 673 | 445 | 255 | 135 | 80 | 80 | 24 | 100 | 148 | 135 |
| 2500WR28 | 2500 | 2-8 | 0,8-3,5 | 1 | 11 | 350 | 330 | 210 | 350 | 330 | 395 | 310 | 15 | 15 | 817 | 673 | 445 | 255 | 135 | 80 | 80 | 24 | 100 | 148 | 135 |
| 3200W4 | 3200 | 4 | 3 | 2 | 10 | 350 | 330 | 250 | 320 | 300 | 495 | 310 | 15 | 15 | 817 | 673 | 445 | 305 | 85 | 80 | 80 | 24 | 100 | 155 | 137 |
| 3200WR14 | 3200 | 1-4 | 0,7-3 | 2 | 10 | 350 | 330 | 250 | 350 | 330 | 495 | 310 | 15 | 15 | 817 | 673 | 445 | 305 | 85 | 80 | 80 | 24 | 100 | 155 | 137 |
| 4000W4 | 4000 | 4 | 3 | 2 | 11 | 350 | 390 | 250 | 320 | 330 | 505 | 310 | 15 | 15 | 817 | 673 | 445 | 305 | 85 | 80 | 80 | 24 | 100 | 158 | 145 |
| 4000WR14 | 4000 | 1-4 | 0,7-3 | 2 | 11 | 350 | 390 | 250 | 350 | 330 | 505 | 310 | 15 | 15 | 817 | 673 | 445 | 305 | 85 | 80 | 80 | 24 | 100 | 158 | 145 |
| 5000W4 | 5000 | 4 | 3 | 2 | 11 | 350 | 390 | 250 | 320 | 330 | 505 | 310 | 15 | 15 | 817 | 673 | 445 | 305 | 85 | 80 | 80 | 24 | 100 | 163 | 155 |
| 5000WR14 | 5000 | 1-4 | 0,8-3,5 | 2 | 11 | 350 | 390 | 250 | 350 | 330 | 505 | 310 | 15 | 15 | 817 | 673 | 445 | 305 | 85 | 80 | 80 | 24 | 100 | 163 | 155 |

Type CS-CE dimensions

Low headroom - Type CS

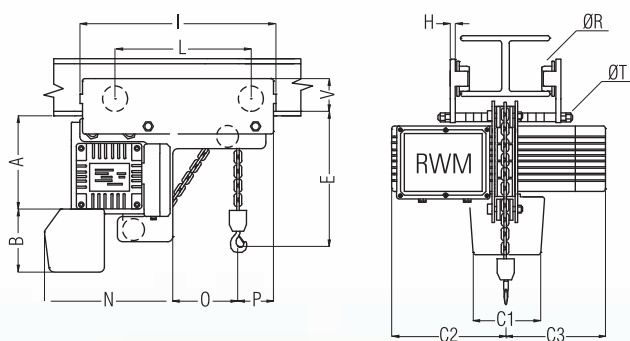

Low headroom - Type CE

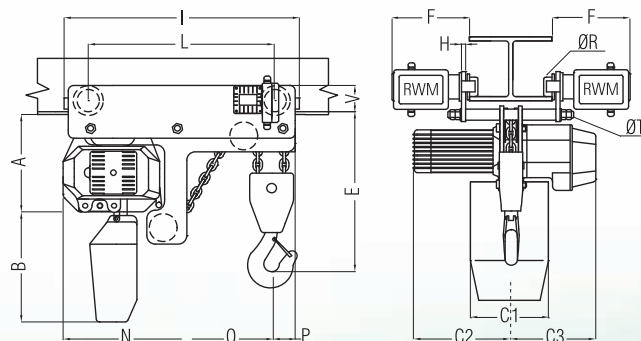

Single phase W series

electric chain hoists



| Capacity kg | Speed m/min. | Kw | Pull of chain | Ø chain |
|-------------|--------------|-----|---------------|---------|
| 125 | 5 | 0,5 | 1 | 4 |
| 125 | 8 | 0,5 | 1 | 4 |
| 250 | 5 | 0,5 | 1 | 4 |
| 250 | 8 | 0,8 | 1 | 4 |
| 500 | 4 | 0,8 | 1 | 5 |
| 500 | 6 | 1,5 | 1 | 7 |
| 1000 | 4 | 1,5 | 1 | 7 |

Electric chain hoists 230 V single phase. FEM clas 1 Am R.I. 30%. Available with special tension 110V single phase.

Trolley electrical

RWM power travel trolley's can be fitted to all models of RWM hoists and are used when the load needs to be traversed laterally along a beam. They are fabricated with heavy duty side plates and fitted with anti-drop plates. They have precision machined steel wheels running on permanently sealed for life bearings, braked motors and have travel limits fitted as standard to prevent the hoist being run into the beam end stops, preventing damage.

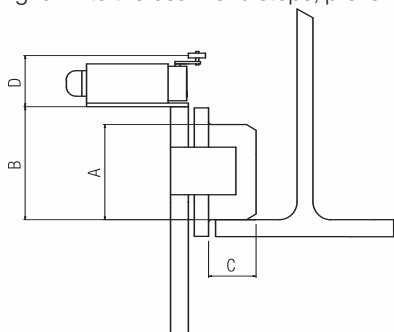

Trolley electrical motors

| Direction speed | 7 m/min | 14 m/min | 7/14 m/min |
|----------------------|---------|----------|------------|
| kW da 125 a 2.000 | 0,2 kW | 0,2 kW | 0,1/0,2 kW |

Motor with conic brake.

| | | | |
|------------------------|--------|--------|------------|
| kW da 2.500 a 5.000 | 0,5 kW | 0,5 kW | 0,2/0,5 kW |
|------------------------|--------|--------|------------|

Motor with electromagnet brake 220VDC.

Minimum radius 900 mm.

| Wheels dimensions | A | B | C | D | Beam size minimum |
|-------------------|----|-----|----|----|-------------------|
| Type 1 | 50 | 70 | 15 | // | 46 |
| Type 2 | 65 | 90 | 25 | 60 | 64 |
| Type 3 | 70 | 94 | 29 | 63 | 73 |
| Type 4 | 80 | 108 | 38 | 57 | 82 |

Reference to the R letter of labels.

Chain

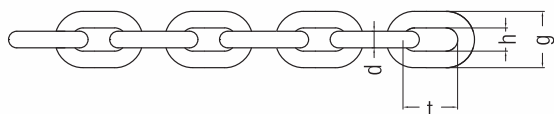

| Weight kg/m | d | t | h | g |
|-------------|----|----|------|------|
| 0,35 | 4 | 12 | 5 | 13,7 |
| 0,54 | 5 | 15 | 6 | 16,9 |
| 1,1 | 7 | 22 | 8,4 | 23,6 |
| 2,2 | 10 | 28 | 12 | 34 |
| 2,7 | 11 | 31 | 13,2 | 37,4 |

Calibrated chain EN 818-7.

Hook models

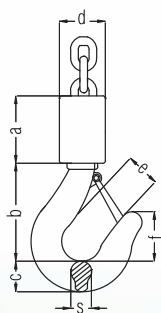

Bottom block T1

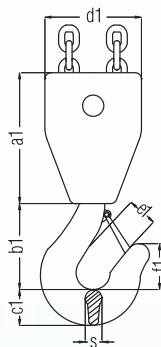

Bottom block T2

| Hook n° | Capacity kg | a | b | C | d | e | f | g | s |
|---------|-------------|-----|-----|----|----|----|----|----|----|
| 012 | 125 | 62 | 81 | 19 | 50 | 24 | 32 | 30 | 19 |
| 012 | 250 | 62 | 81 | 19 | 50 | 24 | 32 | 30 | 19 |
| 025 | 500 | 62 | 88 | 22 | 50 | 28 | 41 | 36 | 20 |
| 05 | 1000 | 72 | 110 | 29 | 50 | 34 | 45 | 43 | 29 |
| 1 | 2000 | 88 | 135 | 38 | 60 | 40 | 68 | 50 | 38 |
| 1 | 2500 | 114 | 135 | 38 | 78 | 40 | 68 | 50 | 38 |

Bottom block 1/1 DIN 15401.

| Hook n° | Capacity kg | a1 | b1 | c1 | d1 | e1 | f1 | g1 | s1 |
|---------|-------------|-----|-----|----|-----|----|----|----|----|
| 1 | 1500 | 194 | 135 | 38 | 142 | 40 | 68 | 50 | 38 |
| 1 | 2000 | 194 | 135 | 38 | 142 | 40 | 68 | 50 | 38 |
| 1 | 3000 | 213 | 135 | 45 | 152 | 40 | 68 | 50 | 38 |
| 1,6 | 4000 | 213 | 145 | 45 | 152 | 45 | 73 | 56 | 45 |
| 1,6 | 5000 | 213 | 145 | 45 | 152 | 45 | 73 | 56 | 45 |

Bottom block 2/1 DIN 15401.